

Instructions

Dismounting Washer

DMW
951-5

Following the procedures detailed herein will ensure that the Expander System Dismounting Washer is used correctly.

IMPORTANT: Do not use your Dismounting Washer until you have read and understood the information contained in these instructions.

FOR QUESTIONS CALL YOUR LOCAL DEALER.

Section 1 - Dismounting Instructions

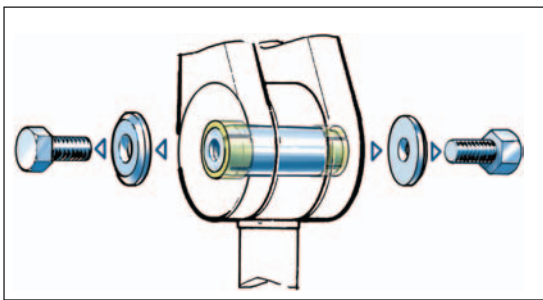

1.1 Unscrew the fastening elements on both sides of the assembly and remove the washer

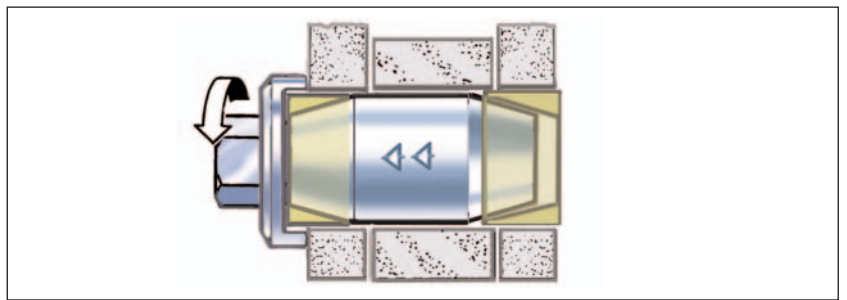

1.2 Install the dismounting washer, with the color facing the lug ear, and the fastening element. Tighten the fastener with a torque wrench according to the schedule below. As you tighten the fastening element it will pull the Expander pin axially towards the bottom of the dismounting washer. The expansion sleeve on the opposite side is now released.

Bolts and Specialty Fasteners



UNIT	M12	M14	M16	M20	M24	M30	M36	M42
(Nm)	70	115	175	350	500	600	700	900
(Lbft)	52	85	129	258	369	443	516	664

Nuts: Standard Height



UNIT	M12	M14	M16	M20	M24	M30	M36	M42
(Nm)	65	115	175	250	350	500	600	700
(Lbft)	48	85	129	184	258	369	443	516

Nuts: Low Height



UNIT	M12		M16	M20	M24	M30		
(Nm)	60		125	200	275	350		
(Lbft)	44		92	148	203	258		

Spanner Nuts



UNIT	M17	M25	M35	M45	M55	M65	M75	M85
(Nm)	50	120	250	500	600	700	800	900
(Lbft)	37	89	184	369	443	516	590	664

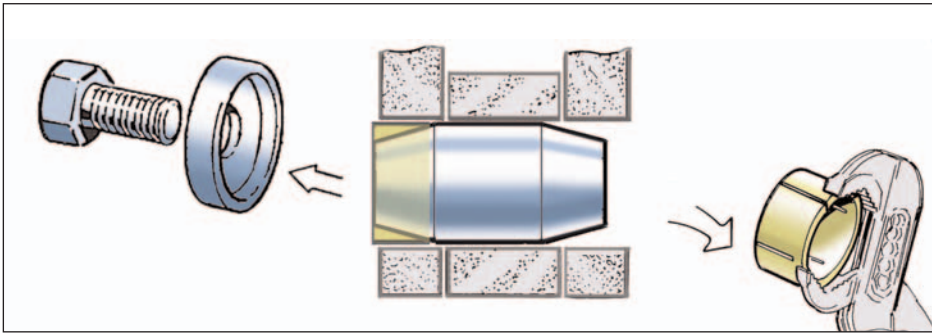

1.3 Unscrew the fastening element and remove the dismantling washer. Remove the expansion sleeve on the opposite side with channel lock pliers or similar tool.

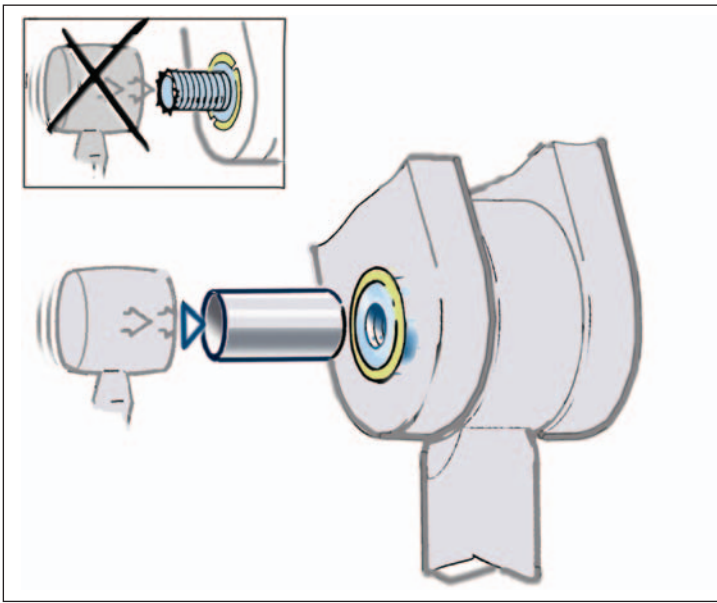

1.4 Tap the Expander pin body alternately on both sides until the expansion sleeves come loose. Use a piece of plumbing pipe between the Expander pin and the mallet/hammer in order **NOT TO DAMAGE THE THREADS**. Make sure that the pipe does not come in contact with the expansion sleeve.

If excessive force is needed or if space is limited go back to **Section 1.2** and install the dismantling washer on the opposite side.

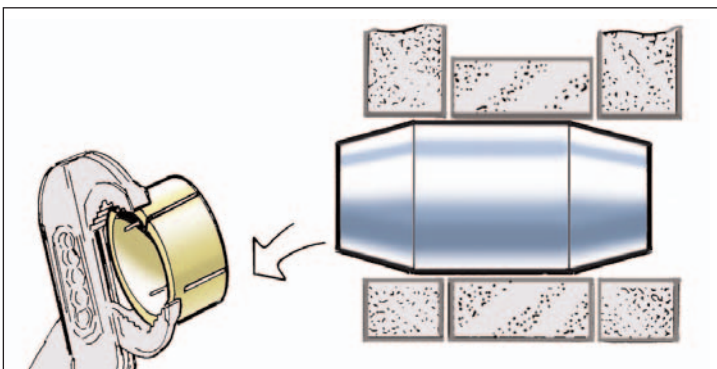

1.5 Remove the expansion sleeve on the opposite side with channel lock pliers or similar tool. Then remove the Expander pin.

IMPORTANT: For instructions on re-installation of the Expander System, contact your local dealer or visit www.ExpanderSystem.com, choose a language and click "download document".



SWEDEN

Svenska Expander AB
 P.O. Box 217, SE-597 25
 Åtvidaberg
 Sweden
 Phone: +46 - 120 - 299 00
 Fax: +46 - 120 - 355 88

USA / CANADA

Expander Americas, Inc.
 P.O. Box 4538,
 Sedona, AZ 86340
 USA
 Phone: 888-935-3884
 Fax: 888-935-3643

UNITED KINGDOM

Expander U.K. Limited
 P.O. Box 3965
 CV34 9AJ Warwick
 United Kingdom
 Phone: + 44 - 1453 - 757 077
 Fax: + 44 - 1453 - 759 096

GERMANY

Expander Deutschland GmbH
 Zollstrasse 54-56,
 DE-89407 Dillingen-Fristingen
 Germany
 Phone: + 49 - 9071 - 4123
 Fax: + 49 - 9071 - 711 35